



TRADING UPDATE
THIRD QUARTER

2020



> EXECUTIVE SUMMARY 3Q20 AT A GLANCE

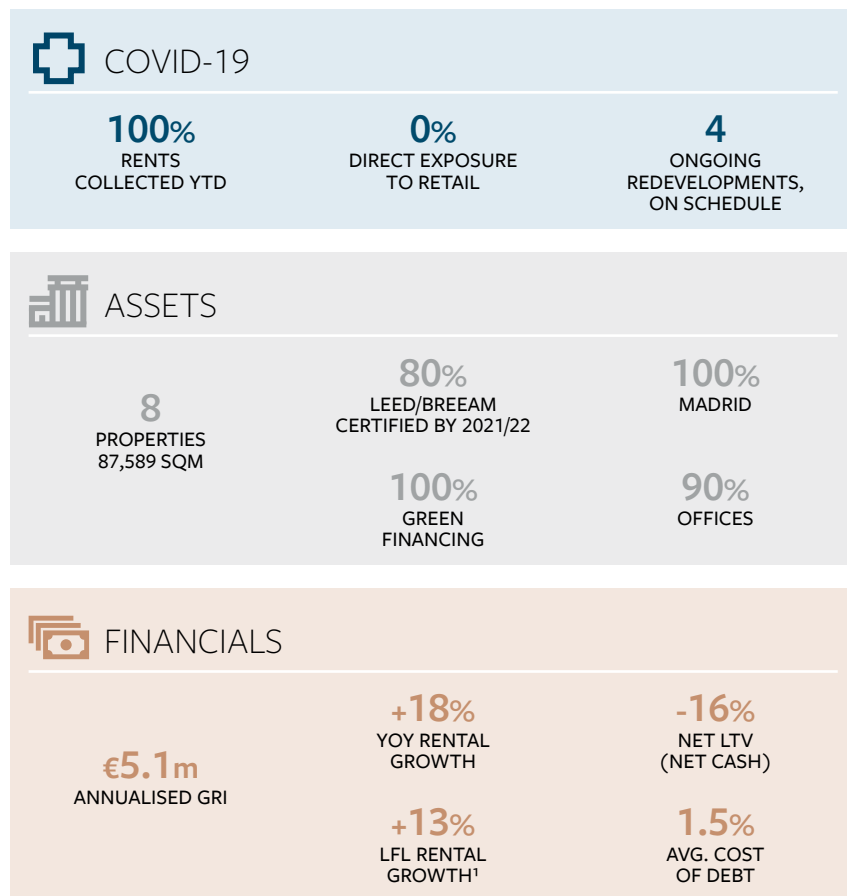

Notes: **(1)** 12-month like-for-like compares with the same investment properties included in the portfolio at 30 September 2019; **(2)** LS7 renamed Cadenza for commercial purposes; **(3)** Weighted average; all-in costs include spread, up-front costs and hedge; forward swaps starting in 2021; **(4)** Royal Institution of Chartered Surveyors

RESILIENT FINANCIAL PERFORMANCE, LARGELY UNAFFECTED BY COVID-19

- Rent collection remains strong at 100% year-to-date, with no exposure to retail or leisure. Working closely with tenants and implementing safety preventive measures in all buildings
- Gross rental income for the 9-month period of EUR 3.8m, +18% YoY and +13% on a like-for-like basis¹. Annualised GRI at Sep'20 of EUR 5.1m
- 50% of portfolio undergoing refurbishment works, hence not yet contributing to Árima's P&L
- Net profit of EUR 2.4m, and EPS of EUR 0.09 p.s.

SIGNIFICANT PORTION OF THE PORTFOLIO IN EARLY STAGE OF REPOSITIONING

- Strong redevelopment pipeline continues to advance according to schedule, with works resumed post lockdown: 4 office schemes (40,000 sqm: Habana, Botanic, Cadenza² and Manoteras), all in Madrid
- Ongoing works expected to be completed by year-end 2021 (Habana, Botanic, Cadenza) and year-end 2022 (Manoteras)

DEFENSIVE PORTFOLIO WITH SUBSTANTIAL UPSIDE POTENTIAL

- Unique portfolio built through disciplined and accretive acquisitions at very competitive prices
- +155% GRI upside potential even applying a more conservative, in-house view of rental levels
- 6.0%-6.5% ERV yield post-capex vs c. 3.5%-4% market yield

SOLID BALANCE SHEET TO WEATHER ANY POTENTIAL STORM

- Strong liquidity position, with EUR144m in cash and equivalents at quarter-end and a net cash position of EUR 41m (16% net cash)
- Best-in class financing conditions: 1.5% all-in costs³ for a 7-year weighted average maturity, and 95% repayments due from 2025 onwards

SUSTAINABILITY AND CORPORATE RESPONSIBILITY AT THE CORE

- 100% of portfolio fully financed with green loans
- 80% of portfolio expected to be LEED/BREEAM certified in 2021/22
- 100% of repositioning projects expected to be WELL certified in 2021/22
- 2020 GRESB assessment above expectations, and on track to be top-ranked in 2021
- EPRA BPR Most Improved Award, achieving Silver level
- The only RICS-accredited⁴ commercial real estate company in Spain



It is reassuring that we remain in a position of great strength with a portfolio full of opportunity, low gearing and ample liquidity. Despite the near-term uncertainty, we strongly believe in the long-term prospects of our strategy and our portfolio. However, market activity remains subdued. We are taking a very prudent investment approach with a highly selective pipeline — Luis López de Herrera-Oria, Chief Executive Officer

> FINANCIAL RESULTS



> FINANCIAL RESULTS

> KEY INCOME STATEMENT METRICS

€'m unless specified	30/09/2019	30/09/2020
Gross Rental Income (GRI)	3.231	3.820
Net Rental Income (NRI)	2.981	3.504
EBIT	15.758	3.231
Net profit	15.281	2.420
EPS (€ p.s.)	1.22	0.09

> KEY BALANCE SHEET ITEMS

€'m unless specified	30/09/2019	30/09/2020
Gross Asset Value (GAV)¹	175.566	253.220
Gross Debt	65.087	104.130
Cash & Equivalents	39.684	144.756
Net Debt	25.403	(40.626)
Gross LTV	37%	41%
Net LTV	14%	(16%)

RESILIENT FINANCIAL PERFORMANCE, WITH EXISTING PORTFOLIO LARGELY UNAFFECTED BY COVID-19

- Rent collection remains strong at 100% YTD. No exposure to retail and no corporate tenants operating in the industries most impacted by COVID-19²
- Gross rental income for the 9-month period of EUR 3.8m, +18% YoY and +13% on a like-for-like basis
- Annualised GRI at Sep'20 of EUR 5.1m
- NRI margin at 92%, despite the higher number of assets under refurbishment
- Net profit of EUR 2.4m, and EPS of EUR 0.09 p.s.

SIGNIFICANT PORTION OF THE PORTFOLIO IN EARLY STAGE OF REPOSITIONING, AS PER BUSINESS PLAN

- Redevelopment works (50% of portfolio: Habana, Botanic, Cadenza³ and Manoteras) continue to advance according to schedule, with works resumed post lockdown
- All ongoing works not yet contributing to Árima's P&L, expected to be completed by year-end 2021 and year-end 2022

ROBUST BALANCE SHEET TO WEATHER ANY POTENTIAL STORM AND SEIZE MARKET OPPORTUNITIES

- Strong liquidity position with EUR144m in cash and equivalents at period-end
- EUR 41m net cash position and -16% net LTV (net cash)
- Best-in class financing conditions:
 - 100% of Árima's financing composed of green loans
 - 1.5% all-in costs⁴ for a 7-year weighted average maturity
 - 95% repayments due from 2025 onwards

> DEBT MATURITY PROFILE AS OF 30.09.2020

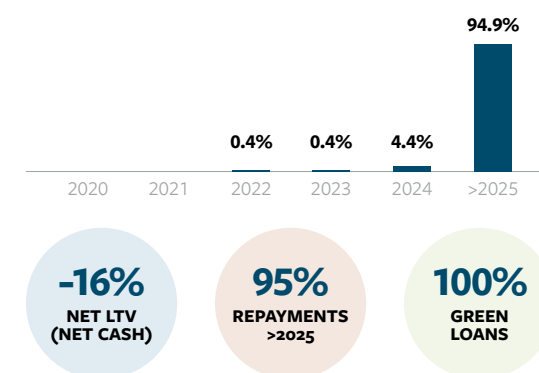

Notes: (1) Based on the external independent valuation carried out by CBRE Valuation Advisory (RICS) at 30 June 2019 and 30 June 2020; (2) Source: S&P Global Market Intelligence; (3) LS7 renamed Cadenza for commercial purposes; (4) Weighted average; all-in costs include spread, up-front costs and hedge; forward swaps starting in 2021

> PORTFOLIO OVERVIEW



> PORTFOLIO OVERVIEW ASSET MAP

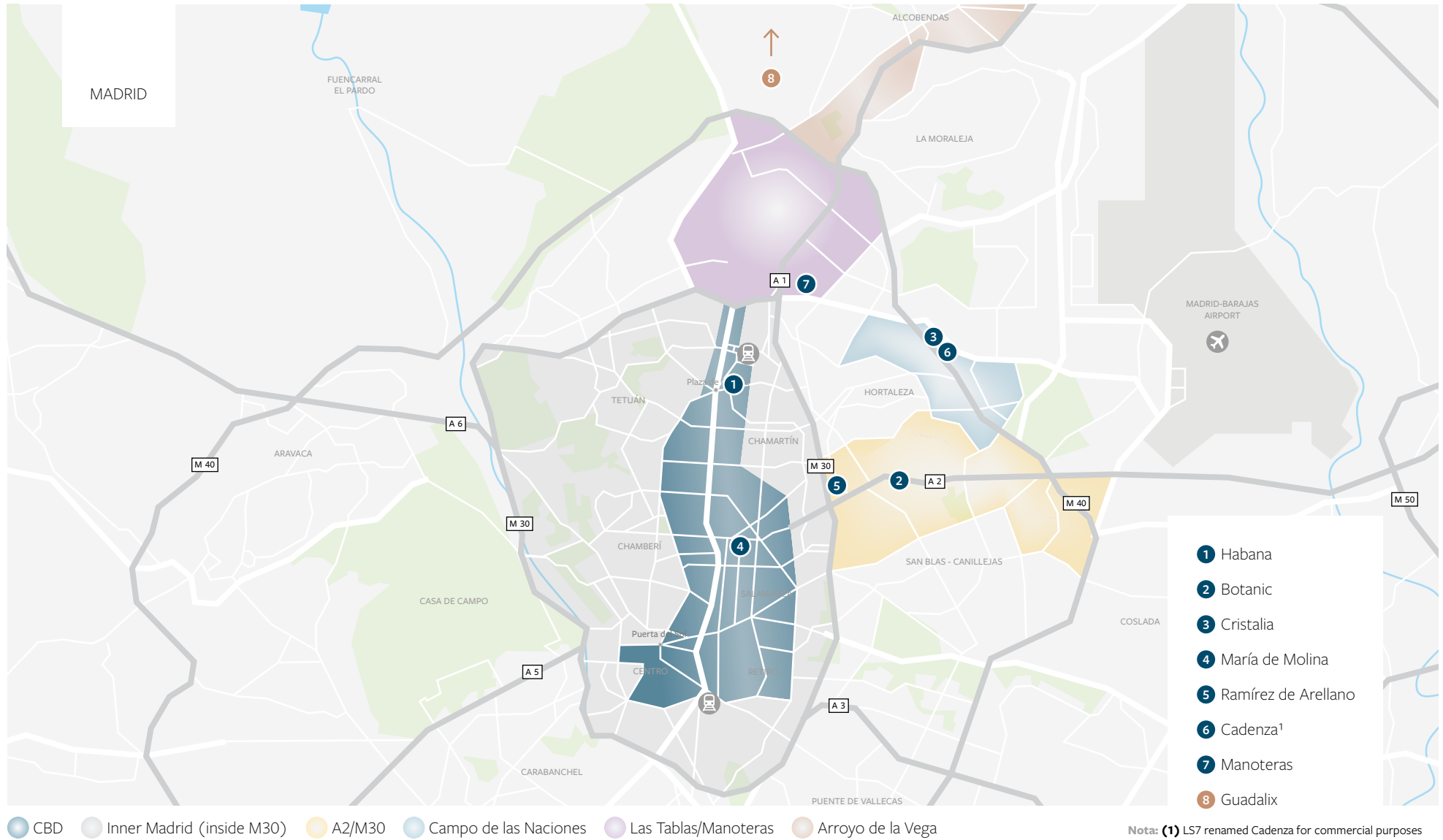

> PORTFOLIO OVERVIEW PORTFOLIO BREAKDOWN

UNIQUE PROPOSITION WITH CLEAR FOCUS ON MADRID OFFICES BUILT VIA DISCIPLINED AND ACCRETIVE ACQUISITIONS

> PORTFOLIO BREAKDOWN

GAV BY SECTOR

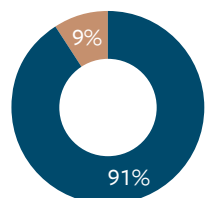

● Offices ● Logistics

GAV BY LOCATION

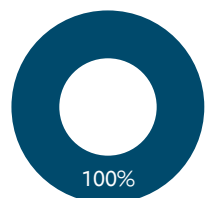

● Madrid

EUR m. unless specified	Assets (#)	GLA (sqm)	Parking (slots) ¹	Acq Price (EURm)	Acq Cost (EURm)	Acq Price (€/sqm) ²	GAV ³ (EURm)	Occupancy rate	Annualised GRI "Topped-up" (€'000)	Annualised NRI (€'000)	Gross yield "Topped-up"	EPRA NIY "Topped-up"
INVESTMENT PROPERTIES												
Offices	3	21,807	332	95	98	4,048	104	70%	3,255	2,770	3.4%	2.8%
Madrid	3	21,807	332	95	98	4,048	104	70%	3,255	2,770	3.4%	2.8%
CBD	1	4,120	20	24	24	5,558	31	14%	0,145	0,045	0.6%	0.1%
Inner Madrid (M30)	1	6,759	110	32	33	4,315	32	100%	1,456	1,427	4.5%	4.4%
Greater Madrid	1	10,928	202	39	40	3,314	41	72%	1,654	1,298	4.2%	3.5%
Logistics	1	25,694	0	16	17	638	23	100%	1,815	1,018	11.1%	7.5%
Madrid	1	25,694	0	16	17	638	23	100%	1,815	1,018	11.1%	7.5%
Total investment properties	4	47,501	332	112	115	2,204	127	86%	5,070	3,788	4.5%	3.6%
REDEVELOPMENTS												
Offices	4	40,088	711	95	98	2,100	127					
Madrid	4	40,088	711	95	98	2,100	127					
CBD	1	4,236	42	19	19	4,070	25					
Inner Madrid (M30)	-	-	-	-	-	-	-					
Greater Madrid	3	35,852	669	77	79	1,868	102					
Logistics	0	0	0	0	0	-	0					
Madrid	0	0	0	0	0	-	0					
Total Redevelopments	4	40,088	711	95	98	2,100	127					
Total Portfolio	8	87,589	1,043	207	213	2,204	253					

Notes: (1) Includes underground parking slots only; other types such as overground slots or moto slots are not included in this figure; (2) Adjusted for parking; (3) Most recent valuation + acquisition price

> PORTFOLIO OVERVIEW PORTFOLIO IN DETAIL



OFFICES

Name: Habana
 Acq. Date: Dec'18
 Location: Madrid CBD
 GLA: 4,300 sqm
 Parking units: 65
 Strategy: Full Refurbishment

- **Free-standing office building** located in Madrid Prime CBD, with spacious floor plates of c. 1,000sqm
- Acquired **c.40% below comparable market transactions**
- **Significant reversionary potential** through full refurbishment. LEED & WELL Gold certifications expected
- Refurbishment works ongoing
- Project enhanced with **COVID and safety preventive measures**
- Have already received interest from prospective tenants



OFFICES

Name: Botanic²
 Acq. Date: Jan'19
 Location: Madrid A2/M30
 GLA: 9,462 sqm
 Parking units: 212
 Strategy: Partial Refurbishment

- **Prominent office building** located in Madrid A2/M30 sub- market, with excellent visibility
- Acquired **c.10% below comparable market transactions**
- **Significant reversionary potential** through asset repositioning and re-leasing. LEED Platinum and WELL Gold certifications expected
- Refurbishment works ongoing upon termination of existing lease
- Project enhanced with **COVID and safety preventive measures**
- Already receiving interest from prospecting tenants



OFFICES

Name: Cristalia
 Acq. Date: Jan'19
 Location: Madrid CDN
 GLA: 10,928 sqm
 Parking units: 202
 Strategy: Lease up & re-leasing

- **Free-standing office building** located in Campo de las Naciones Madrid sub-market, a **highly sought** after business park with a strong tenant roster
- **Highly-efficient** building with **LEED Gold** certification and column-free floor plates of 1,400 sqm
- Acquired **c.20% below comparable market transactions**
- **Attractive reversionary potential** through re-gearing existing leases and leasing-up vacant space. **Partially occupied (72%)** to a world leading insurance and TMT company.
- Implemented **COVID and safety preventive measures**



OFFICES

Name: M. Molina
 Acq. Date: Dec'18-Feb'19
 Location: Madrid CBD
 GLA: 4,122 sqm
 Parking units: 24
 Strategy: Single Onwership

- **Free-standing office building** located in Madrid Prime CBD, with spacious floor plates of c. 1,000sqm
- Acquired **c.30% below comparable market transactions**
- **Complex transaction**, with a multi-owner structure. **Floor-by-floor refurbishment** already completed
- Value creation strategy includes **consolidation of single ownership, with negotiations underway**
- Implemented **COVID and safety preventive measures**

Notes: **(1)** Source: CBRE Research for comparable transactions as of Feb'20, Árima for portfolio data. Árima assets include acquisition price and expected capex, i.e. total investment; **(2)** América renamed as Botanic for commercial purposes

> PORTFOLIO OVERVIEW PORTFOLIO IN DETAIL



OFFICES

Name: Ramírez de Arellano
Acq. Date: Jun'19
Location: Inner Madrid (M30)
GLA: 6,759 sqm
Parking units: 110
Strategy: Regearing

- **Free-standing office building** located in the well-established Avenida de América-Torrelaguna Madrid sub-market
- Acquired **in line with comparable market transactions**⁽¹⁾
- **Highly-efficient** building with **BREEAM "Very Good"** building, and column-free flexible floor plates of over 1,000sqm
- **Fully occupied** with high-quality tenant, and **strong reversionary potential** through re-leasing medium-term
- Implemented COVID and safety preventive measures



OFFICES

Name: Cadenza²
Acq. Date: Dec'19
Location: Madrid CDN
GLA: 14,500 sqm
Parking units: 196
Strategy: Full Refurbishment

- **Free-standing office building** located in Campo de las Naciones Madrid sub-market, to the new ING 35,000 sqm HQ
- Acquired **c.20% below comparable market transactions**⁽¹⁾
- **Excellent visibility**, and large floor plates (2,865sqm) and common areas with great potential
- **Significant reversionary potential** upon completion of refurbishment works.
- Refurbishment already ongoing and LEED & WELL Gold certifications expected and COVID prevention measures applied



OFFICES

Name: Manoteras
Acq. Date: Jun'20³
Location: Las Tablas/Manoteras
GLA: 11,962 sqm
Parking units: 245
Strategy: Full Refurbishment

- New build turnkey project of a free-standing Class A office building in the Manoteras Madrid sub-market, the extension of Castellana's Madrid CBD
- **Excellent location and connections** to public transport as well as motorway networks
- Large, bright and highly-efficient floor plates (2,000sqm), and common areas with great potential
- Acquired at a material market discount through an off-market transaction
- Significant reversionary potential upon completion of refurbishment works. LEED Platinum and WELL Gold certifications expected



LOGISTICS

Name: Guadalix
Acq. Date: Apr'19
Location: Madrid (2nd ring)
GLA: 25,694 sqm
Loading bays: 29
Strategy: Re-gearing

- **Prime logistics** warehouse located in San Agustín de Guadalix, a consolidated industrial estate 30km north of Madrid, with **excellent access**
- Acquired **c.20% below comparable market transactions**⁽¹⁾
- **High-yielding** cold storage facility with a **long-term lease**, acquired well below replacement cost
- Value creation strategy includes longer term restructuring of the unit's occupation to improve liquidity and mortgageability
- Tenant has experienced a very high level of activity during the last months

Notes: **(1)** Source: CBRE Research for comparable transactions as of Feb'20, Árima for portfolio data. Árima assets include acquisition price and expected capex, i.e. total investment; **(2)** LS7 renamed Cadenza for commercial purposes; **(3)** The private "turnkey" sale agreement was executed in June 2020. It is expected that the building will be delivered, upon completion, before December 2022.

> ACTIVE ASSET MANAGEMENT



> ACTIVE ASSET MANAGEMENT PORTFOLIO UPSIDE POTENTIAL

EXISTING PORTFOLIO WITH SIGNIFICANT UPSIDE POTENTIAL IN THE NEXT 2-3 YEARS THROUGH ACTIVE ASSET MANAGEMENT

COVID-19 update: near-term uncertainty but confident of the long-term opportunity. Substantial upside potential remains even applying a more conservative, in-house view of rental levels.

> PORTFOLIO – GROSS RENTAL INCOME EXPECTED EVOLUTION (AT CURRENT MARKET RENTS)

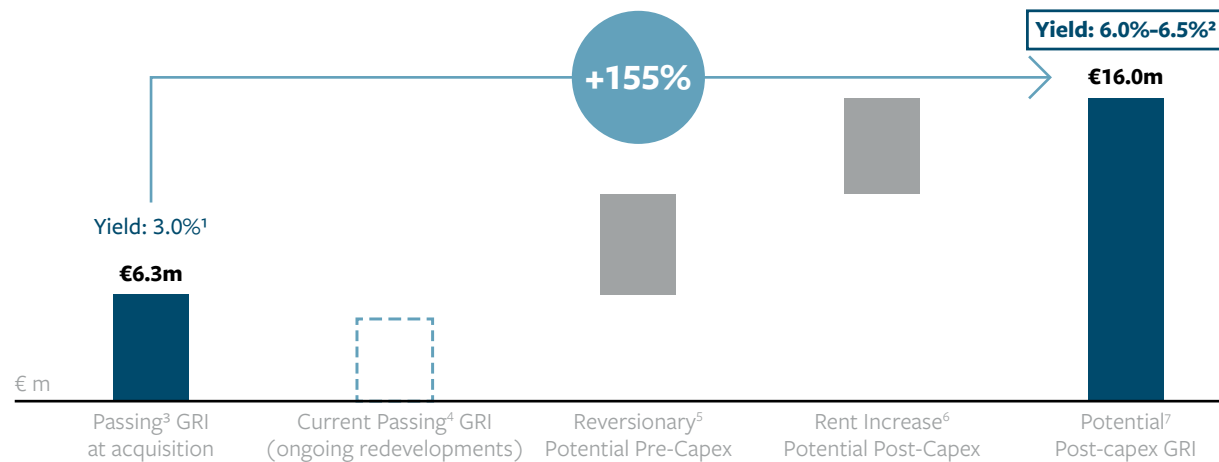

STRONG FOCUS ON ASSET IMPROVEMENT

> BY GAV

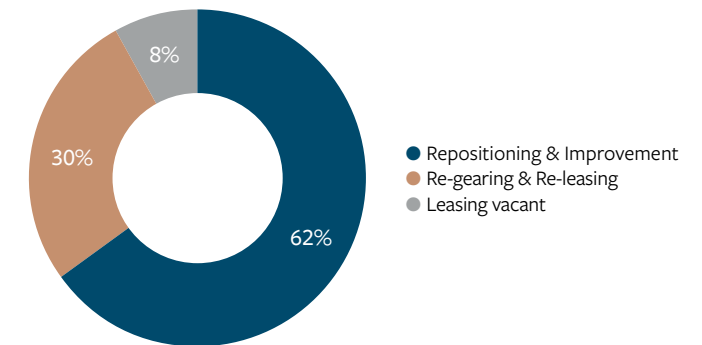

Notes: **(1)** Passing gross yield defined as passing gross rents over total portfolio acquisition price; **(2)** Yield on cost defined as post-capex GRI divided by total investment (net acquisition cost plus expected capex); **(3)** Annualized gross rents; **(4)** Lease in office building América terminated ahead of refurbishment works; **(5)** Includes mark-to-market of existing rents and leasing vacant space; **(6)** Expected increase in rents from capex investments; **(7)** Expected gross rental income after realizing reversionary potential and effects from capital expenditures

> ACTIVE ASSET MANAGEMENT ACTIVE ASSET MANAGEMENT PLAN

PROPERTY MANAGEMENT DESIGNED TO CAPTURE GRADE-A DEMAND AND IMPROVE TENANT EXPERIENCE

COVID-19 update: minor delays during lockdown but deliveries expected on schedule

→ Redevelopment and asset management plan progressing well on schedule

→ Assets follow different **value-add strategies**

→ Combination of different strategies leading to a **balanced portfolio with significant upside**

→ **Refurbishment** and redevelopment expected to improve asset quality and capture additional rent upside in its area of influence

→ **Leasing vacant**, re-gearing and **maximising occupancy**

→ **Innovation & technology:** focus on efficiency and services

> REDEVELOPMENT & ASSET MANAGEMENT PLAN

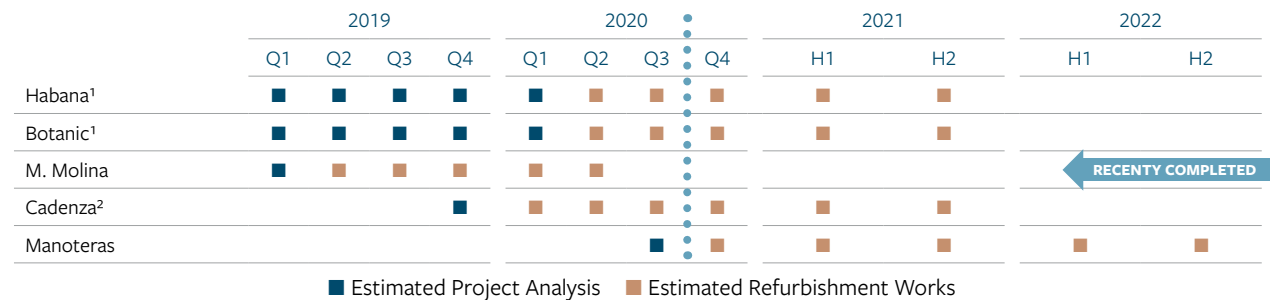

> VALUE CREATION STRATEGY

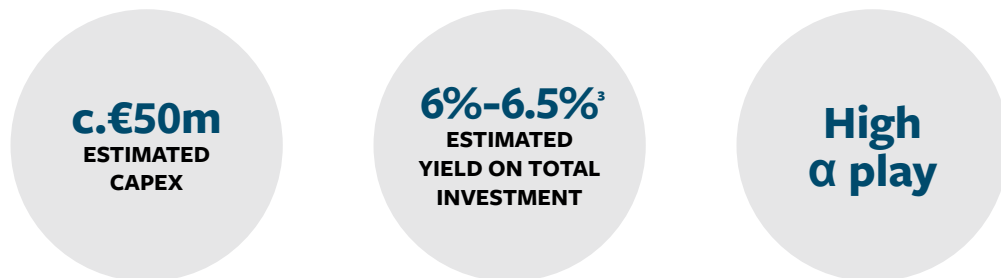

Notes: (1) Botanic and Habana lease agreements with existing tenant terminated in Dec'19 and Feb'20 respectively. Refurbishment works in those assets in progress since May 2020; (2) LS7 renamed Cadenza for commercial purposes; (3) Yield on cost defined as post-capex GRI divided by total investment (acquisition cost plus expected capex)

> ACTIVE ASSET MANAGEMENT ONGOING REDEVELOPMENT PROJECTS TO CAPTURE GRADE-A DEMAND THROUGH DIFFERENTIATED HIGH-QUALITY MODERN AND FLEXIBLE SMART SPACE



HABANA
 Location: Madrid CBD
 GLA: 4,300 sqm
 Expected Delivery: H2 2021



BOTANIC
 Location: Madrid A2/M30
 GLA: 9,462 sqm
 Expected Delivery: H2 2021



CADENZA²
 Location: Campo de las Naciones
 GLA: 14,500 sqm
 Expected Delivery: H2 2021



MANOTERÁS
 Location: Las Tablas/Manoterás
 GLA: 11,962 sqm
 Expected Delivery: H2 2022

Notes: (1) Yield on cost defined as post-capex GRI divided by total investment (acquisition cost plus expected capex); (2) LS7 renamed as CadENZA for commercial purposes

> SUSTAINABILITY & CORPORATE RESPONSIBILITY



> SUSTAINABILITY & CORPORATE RESPONSIBILITY

COMMITTED TO SUSTAINABLE ENVIRONMENTS AND SOCIAL WELLBEING

SUSTAINABILITY, QUALITY AND HEALTH TOUCH EVERYTHING WE DO

- **Portfolio certification program on track** with redevelopment pipeline:
 - **80% of portfolio** expected to be LEED/BREEAM certified in 2021/22
 - **100% of repositioning projects** expected to be WELL certified in 2021/22
- **Engaged in the 2020 GRESB assessment:**
 - First-year participant only 18-months post-IPO
 - **Results above expectations** and on track to be top-ranked in 2021
- **EPRA member** since IPO
 - **BPR Most Improved Award**, achieving **Silver level**
- The **only RICS-accredited¹** commercial real estate company in Spain

> LEED/BREEAM CERTIFICATION

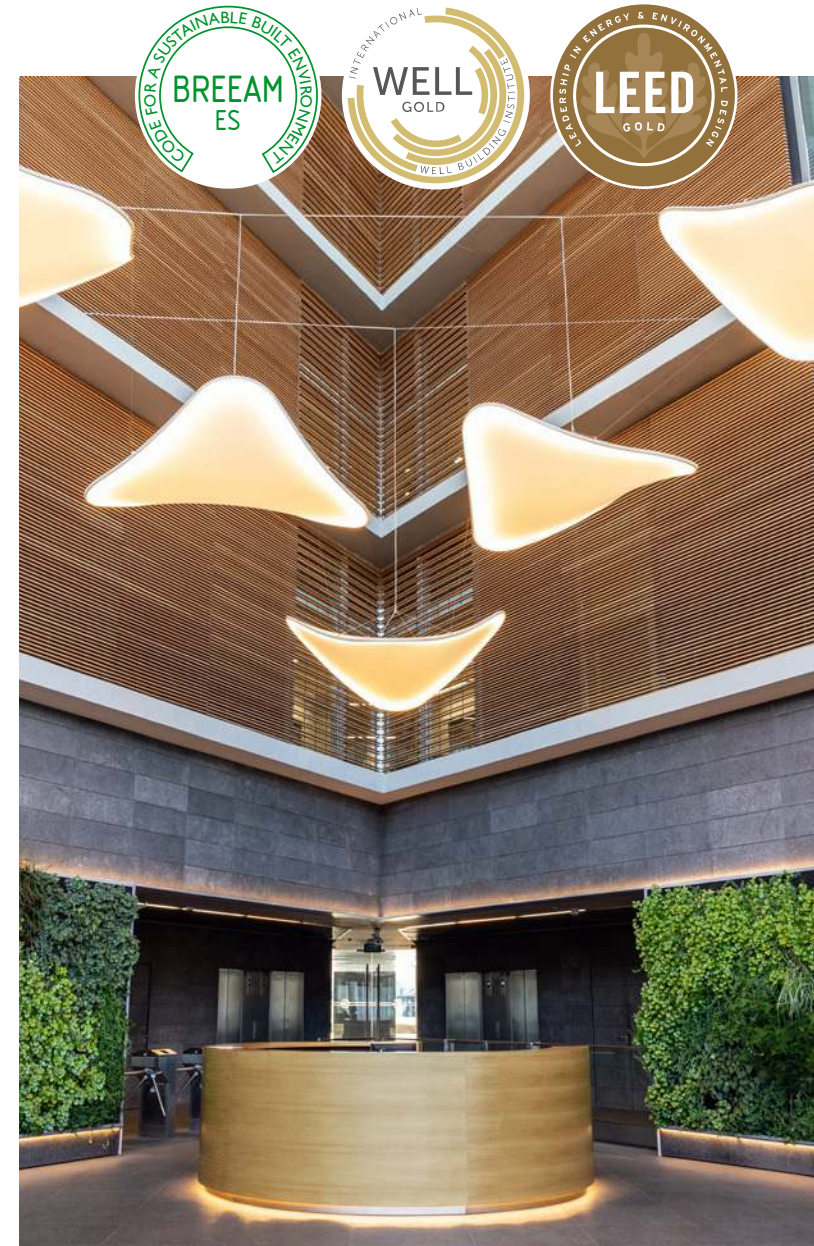
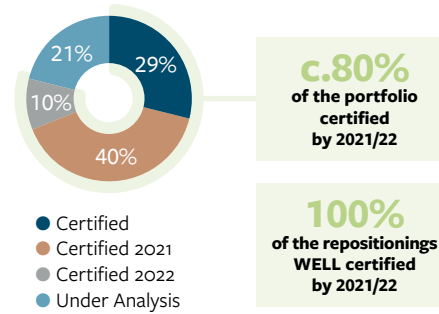

> ROADMAP TO PORTFOLIO LEED, BREEAM & WELL CERTIFICATION

Asset	Certification Type	Sustainability Certification	Health-Safety Certification	Expected Certification Date
Cristalia	LEED Core & Shell	LEED GOLD	WELL GOLD	LEED Certified
Ramírez de Arellano	Breeam In-Use	BREEAM Very Good	Under Analysis	BREEAM Certified
Habana	LEED Core & Shell	LEED GOLD	WELL GOLD	H2 2021
Botanic	LEED Core & Shell	LEED PLATINUM	WELL GOLD	H2 2021 (Pre-Certified)
M. Molina ²	LEED	Under Analysis	Under Analysis	Under Analysis
Guadalix	LEED/BREEAM	Under Analysis	Under Analysis	Under Analysis
Cadenza ³	LEED Core & Shell	LEED GOLD	WELL GOLD	H2 2021
Manoteras	LEED Core & Shell	LEED PLATINUM	WELL GOLD	H2 2022

Notes: (1) Royal Institution of Chartered Surveyors; (2) Final type and status to depend on extent of ownership; (3) LS7 renamed as Cadenza for commercial purposes

> APPENDIX



> APPENDIX Q3 2020 FINANCIALS

> CONSOLIDATED INCOME STATEMENT (P&L)

IFRS		
€'000 (unless otherwise specified)	30/09/2019	30/09/2020
Gross Rental Income (GRI)	3,231	3,820
Non-reimbursable property expenses	(250)	(316)
Net Rental Income (NRI)	2,981	3,504
Overheads	(2,203)	(4,610)
Operating Income (EBITDA)	778	(1,106)
Amortization & Provisions	(7)	(17)
Recurring EBIT	771	(1,123)
Net financial charges	(477)	(811)
Tax	-	-
Recurring net profit	294	(1,934)
Change in fair value of assets	15,033	8,550
Other income and expenses	(46)	(4,196)
Reported net profit	15,281	2,420
Recurring EPS (€ p.s.)	0.02	(0.07)
Reported EPS (€ p.s.)	1.22	0.09
Average no. of shares outstanding	12,572,951	28,048,743

EPRA		
€'000 (unless otherwise specified)	30/09/2019	30/09/2020
EPRA earnings	248	(6,130)
Adjusted EPRA earnings	261	(1,934)
EPRA EPS (€ p.s.)	0.02	(0.22)
Adjusted EPRA EPS (€ p.s.)	0.02	(0.07)

> CONSOLIDATED BALANCE SHEET

IFRS		
€'000 (unless otherwise specified)	30/09/2019	30/09/2020
Non Current Assets	176,758	256,520
Property plant & equipment	125	208
Investment property	175,566	255,420
Long-term financial investments	1,067	892
Current assets	42,437	151,936
Trade and other receivables	2,597	6,839
Prepayments and accrued income	156	341
Cash & cash equivalents	39,684	144,756
Equity	149,257	298,339
Share Capital	140,063	284,294
Share Premium	-	5,769
Reserves	(4,233)	5,447
Treasury shares	(487)	(7,545)
Retained earnings	15,281	2,420
Other	-	7,954
Liabilities	69,938	110,117
Non-current liabilities	67,461	106,329
Financial debt	64,928	103,972
Financial derivatives	1,367	1,446
Other	1,166	911
Current liabilities	2,477	3,788
Financial debt	159	158
Trade & other payables	2,318	3,630
Number of shares outstanding, end of period	13,955,463	27,561,928

> DISCLAIMER

This document has been prepared by Árima real estate socimi, S.A. (the "Company") for information purposes only and it is not a regulated information or information which has been subject to prior registration or control by the Spanish Securities Market Commission. This document is neither a prospectus nor implies a bid or recommendation for investment.

This document includes summarized audited and non-audited information. The financial and operational information, as well as the data on the acquisitions which have been carried out, included in the presentation, corresponds to the internal recordings and accounting of the Company. Such information may have been subject to audit, limited review or any other control by an auditor or an independent third party. Therefore, this information may be modified or amended in the future.

The information contained herein has been obtained from sources that Árima considers reliable, but Árima does not represent or warrant that the information is complete or accurate, in particular with respect to data provided by third parties.

Neither the Company nor its legal advisors and representatives assure the completeness, impartiality or accuracy of the information or opinions included herein. In addition, they do not assume responsibilities of any kind, whether for misconduct or negligence, with regard to damages or loss that may derive from the use of this document or its contents. The internal analysis have not been subject to independent verification. This document may include forward-looking representations or statements on purposes, expectations or forecasts of the Company or its management up to the date of release of this document. Said forward-looking representations and statements or forecasts are mere value judgments of the Company and do not imply undertakings of future performance. Additionally, they are subject to risks, uncertainties and other factors, which were unknown or not taken into account by the time this document was produced and released and which may cause such actual results, performance or achievements, to be materially different from those expressed or implied by these forward-looking statements.

Under no circumstances the Company undertakes to update or release the review of

the information included herein or provide additional information. Neither the Company nor any of its legal advisors or representatives assume any kind of responsibility for any possible deviations that may suffer the forward-looking estimates, forecasts or projections used herein. This document discloses neither all risks nor other material issues regarding the investment on the shares of the Company. The information included in this presentation is subject to, and should be understood together with, all publicly available information. Any person acquiring shares of the Company shall do so on their own risk and judgment over the merits and suitability of the shares of the Company, after having received professional advisory or of any other kind that may be needed or appropriate but not only on the grounds of this presentation. By delivering this presentation, the Company is not providing any advisory, purchase or sale recommendation, or any other instrument of negotiation over the shares or any other securities or financial instrument of the Company. This document does not constitute an offer, bid or invitation to acquire or subscribe shares, in accordance with the provisions of article 30.bis of Law 24/1998, of July 28th, on the Securities Market, and/or the

Royal Decree 1310/2005, of November 4th and their implementing regulations. Furthermore, this document does not imply any purchase or sale bid or offer for the exchange of securities or a request for the vote or authorization in any other jurisdiction. The delivery of this document within other jurisdictions may be forbidden. Consequently, recipients of this document or those persons receiving a copy thereof shall become responsible for being aware of, and comply with, such restrictions.

By accepting this document you are accepting the foregoing restrictions and warnings.

All the foregoing shall be taking into account with regard to those persons or entities which have to take decisions or issue opinions relating to the securities issued by the Company. All such persons or entities are invited to consult all public documents and information of the Company registered within the Spanish Securities Market Commission.

Neither the Company nor any of its advisors or representatives assumes any kind of responsibility for any damages or losses derived from any use of this document or its contents.



ÁRIMA

Árma Real Estate SOCIMI S.A.
Edificio Torre Serrano - Serrano, 47
28001 Madrid
www.arimainmo.com

