

## Press Release

International recognition of the REIT's ambitious sustainability plan

### Árma: excellence in sustainability

- In record time, the company now ranks above the average for European office sector companies on this year's Global Real Estate Sustainability Benchmark (GRESB) assessment, obtaining 4 stars and 85 points (out of a maximum of 100).
- It receives the EPRA sBPR GOLD award, the European Public Real Estate Association's highest honour, in recognition of its transparency in the field of sustainability.
- 80% of the company's portfolio will be LEED/BREEAM certified by 2023, and 100% of its repositioning projects will be WELL certified.
- Árma's flagship and one of the most avant-garde projects in Europe, *Botanic*, will be one of the few buildings in Spain to hold the LEED® PLATINUM, WELL® GOLD and WELL HEALTH & SAFETY certifications.
- The COVID-19 crisis has increased the demand for assets with the highest standards of quality, sustainability, and wellbeing, such as those Árma creates and sells.

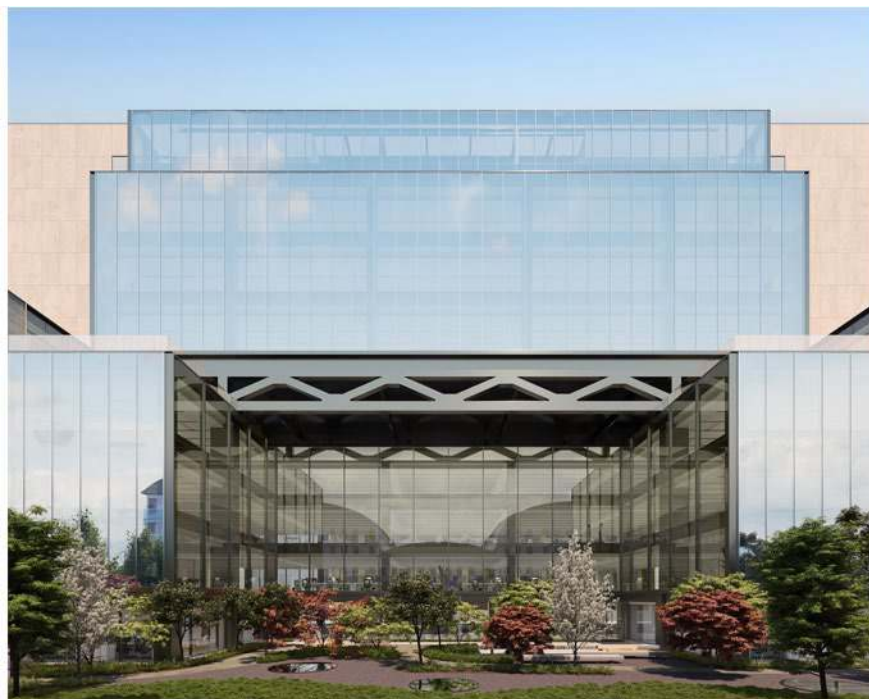

Image: Árma - *Botanic* render



Árma Real Estate SOCIMI, S.A.  
Edificio Torre Serrano  
Serrano, 47 - 4º Izda.  
28001 Madrid - Spain  
T. (+34) 910 532 803  
info@arimainmo.com

**18 October 2021.** The success of Árma's sustainability strategy since its inception, just three years ago, is evident in its outstanding ranking on the *Global Real Estate Sustainability Benchmark* (GRESB), whose 2021 results have just been released, as well as in the awards received from EPRA.

In record time since its debut on the Madrid stock market, the REIT has obtained 4 stars and 85 points (out of a maximum of 100) on the GRESB assessment, the global benchmark of ESG practices in the real estate sector.

The commitment and successful management of such an ambitious and exemplary sustainability strategy has positioned Árma above the average for European office sector specialist companies which have an average age of 41+ years and an average portfolio of 4.05 billion euros – compared to the 293 million euros of Árma's current portfolio.

Within corporate management parameters, Árma performs particularly well in its commitment to stakeholders as well as transparency and leadership. In terms of performance, Árma excels in its responsible consumption of water and power, in addition to building certificates, greenhouse gas emissions, and risk management.

GRESB is an internationally recognised organisation that assesses ESG performance, adapting its requirements to the demands and trends of the market, while advocating ongoing improvement and excellence in corporate responsibility.

## **EPRA**

Árma has received the EPRA sBPR GOLD award, the European Public Real Estate Association's (EPRA) highest honour, in recognition of the data published by the company in the field of sustainability. Árma also received the *Most Improved* distinction in recognition of its extraordinary trajectory.

EPRA defines the standards for the European real estate sector in terms of key financial and sustainability metrics, thus enabling the comparative analyses of companies.

## **Ambitious sustainability roadmap**

Árma's strategy involves equipping its assets to a high degree of quality, sustainability, comfort, and technology. The repositioning of its assets has created the sector's most cutting-edge and attractive workspaces, contributing to the retention of talent and the exceptional wellbeing of occupants. Árma seeks excellence in its buildings, far exceeding market standards.

As part of its ambitious plan, the REIT continues to make progress toward meeting its established objectives: 80% of the company's portfolio will be LEED/BREEAM certified by



Árma Real Estate SOCIMI, S.A.  
Edificio Torre Serrano  
Serrano, 47 - 4º Izda.  
28001 Madrid - Spain  
T. (+34) 910 532 803  
info@arimainmo.com

2023, and 100% of its repositioning projects will be WELL certified, a leading global tool that measures the impact of buildings on people's health and wellbeing.

These results are one step further in the company's sustainability plan, whose financing is endorsed by the best financial institutions and consists of 100% "green" loans.

### ***Botanic, an icon of sustainability***

Spanning nearly 10,000 m<sup>2</sup>, *Botanic* is one of Europe's most avant-garde office spaces, designed to become a standard-bearer in health, efficiency, and wellbeing, and one of the few buildings in Spain to hold the LEED® PLATINUM, WELL® GOLD and WELL HEALTH & SAFETY certifications.

Nature is the project's theme, lending the building its name. *Botanic* has its own 2,500+ m<sup>2</sup> botanical garden with a wide variety of species and an additional 1,000 m<sup>2</sup> of terraces and exterior spaces distributed throughout the various levels.

The company has recently joined the Re-Planta Madrid project, an initiative that aims to replant over 10,000 trees in the city and repair the damage caused by Storm Filomena in the capital.

### **About Árma Real Estate**

*Árma Real Estate is a Spanish Real Estate Investment Trust (SOCIMI for its Spanish acronym) managed by an internal, exclusively dedicated management team created in 2018, with the aim of becoming the benchmark Spanish REIT in Madrid's office market. The company is led by Luis María Arredondo (Chairman of the Board) and Luis López de Herrera-Oria (Chief Executive Officer), and relies on the same reputable management team that ensured the success of Axiare.*

### **For more information:**

Communications Studio: Ana Pereira  
[apereira@estudiodecomunicacion.com](mailto:apereira@estudiodecomunicacion.com) +34 647 88 39 86